



METALLOPRODUKTSIA

Installation manual

Model: Nissan Pathfinder

Skid plate for: fuel tank

Article: 15.1713 V1/15.1714

Body type: R51

Years: 2005-2010-

Engine type: 2,5; 4,0; 3,0D

Engine bay and transmission elements skid plate has been designed and manufactured by LLC Metalloproduktzia. Product conforms to TOR 4591-001-25888788-2006 requirements. Product design is protected by model copyright certificates №89059, 15980, 15981, 15982, 15983. Patented in Russian Federation.

APPLICATION:

Protection of engine bay and transmission elements from mechanical deformation.
Protection of engine bay and transmission elements from dust and damp.

INSTALLATION:

Engine bay and transmission elements skid plate has been designed particularly for a certain vehicle. It should be mounted according to the producer's installation instruction by a dedicated dealer or on certified service stations. The skid plate is fixed to regular apertures located on vehicle's body load-bearing elements. In case of correct installation the skid plate should not interfere with any vehicle's units and components.

INSTALLATION MANUAL:

1. Fix corbel "A" to the cross bar. Mount the bush and the threaded insert inside the beam so that not to damage wires.
2. Fix corbel "B" to the subframe.
3. Fix corbel "C" under OE bolt of the fuel tank fastening.
4. Mount threaded insert "5" into the subframe's aperture.
5. Fix the skid plate to the mounted elements.
6. Tighten all screw joints.

OPERATING CONDITIONS:

Engine bay and transmission elements skid plate has been designed to operate in conditions specified by vehicle's producer. Cases of crush or driving into obstacles at a speed should be excluded during exploitation. In case of head-on crush it is necessary to assure in absence of damages of vehicle's components and units and availability of roadworthiness on certified service stations.

WARRANTY:

Warranty period - 24 months.

WARRANTY TERMS:

The skid plate should be installed on a vehicle with undamaged body and load-bearing elements (vehicle, which has never been involved in road traffic accident);

There are no mechanical damages of the skid plate resulting from head-on crush. All requirements to skid plate installation should be satisfied;

There are no mechanical damages of powder coating.

Producer does not bear liability for damages caused to the vehicle, health and life of people in case of installation and exploitation terms violation. Producer has a right to introduce changes into the skid plate construction.

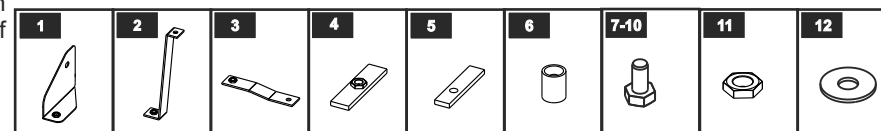
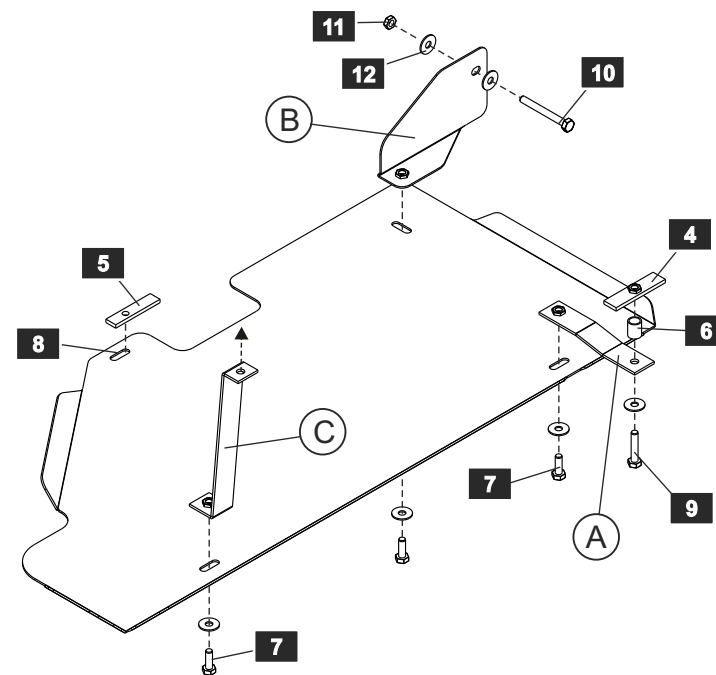

LIST OF PARTS

NO.	NAME	QTY.	NO.	NAME	QTY.
1	Corbel 1	1	7	Bolt M10x30	3
2	Corbel 2	1	8	Bolt M10x40	1
3	Corbel 3	1	9	Bolt M10x50	1
4	Threaded insert	1	10	Bolt M10x90	1
5	Threaded insert	1	11	Nut M10	1
6	Bush	1	12	Washer 10	7

Thread	M6x1.0	M8x1.25	M10x1.5	M12x1.75
Tightening torque	9.8 Nm	24.0 Nm	47.0 Nm	81.0 Nm