



METALLOPRODUKTSIA

Installation manual

Model: VOLKSWAGEN Bora
(Jetta IV) / Golf IV

Skid plate for: engine bay and transmission case

Article: 26.0115

Body type: 1J2; 1J6/1J1; 1J5

Years: 1998 - 2005/1997 - 2003

Engine type: 2.3 V5/2,3 V5; V6 4motion

Engine bay and transmission elements skid plate has been designed and manufactured by LLC Metalloproduktzia. Product conforms to TOR 4591-001-25888788-2006 requirements. Product design is protected by model copyright certificates №89059, 15980, 15981, 15982, 15983. Patented in Russian Federation.

APPLICATION:

Protection of engine bay and transmission elements from mechanical deformation.
Protection of engine bay and transmission elements from dust and damp.

INSTALLATION:

Engine bay and transmission elements skid plate has been designed particularly for a certain vehicle. It should be mounted according to the producer's installation instruction by a dedicated dealer or on certified service stations. The skid plate is fixed to regular apertures located on vehicle's body load-bearing elements. In case of correct installation the skid plate should not interfere with any vehicle's units and components.

INSTALLATION MANUAL:

1. Disassemble the skid plate to component parts.
2. Take away hatch covers located on the front bumper which hide access to the front bumper fasteners.
3. Loosen the 2 bolts with which the front bumper is fixed and mount skid plate's corbels to them.
4. Put the skid plate's beam under the car and fix it to mounted corbels with bolts M10x40 (B) so that the mounted beam is set against longerons.
5. Fix the front part of the skid plate to mounted beam with bolts M10x40 (C).
6. Move the skid plate backward and fix it to the front axle beam with bolts M10x80 and nuts (D).
7. Tighten all screw joints.

OPERATING CONDITIONS:

Engine bay and transmission elements skid plate has been designed to operate in conditions specified by vehicle's producer. Cases of crush or driving into obstacles at a speed should be excluded during exploitation. In case of head-on crush it is necessary to assure in absence of damages of vehicle's components and units and availability of roadworthiness on certified service stations.

WARRANTY:

Warranty period - 24 months.

WARRANTY TERMS:

The skid plate should be installed on a vehicle with undamaged body and load-bearing elements (vehicle, which had never been involved in road traffic accident);
There are no mechanical damages of the skid plate resulting from head-on crush. All requirements to skid plate installation should be satisfied;
There are no mechanical damages of powder coating.
Producer does not bear liability for damages caused to the vehicle, health and life of people in case of installation and exploitation terms violation. Producer has a right to introduce changes into the skid plate construction.

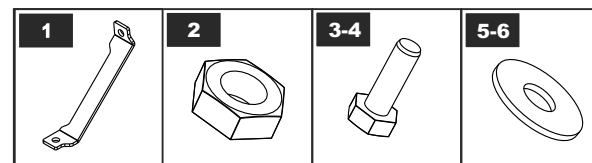
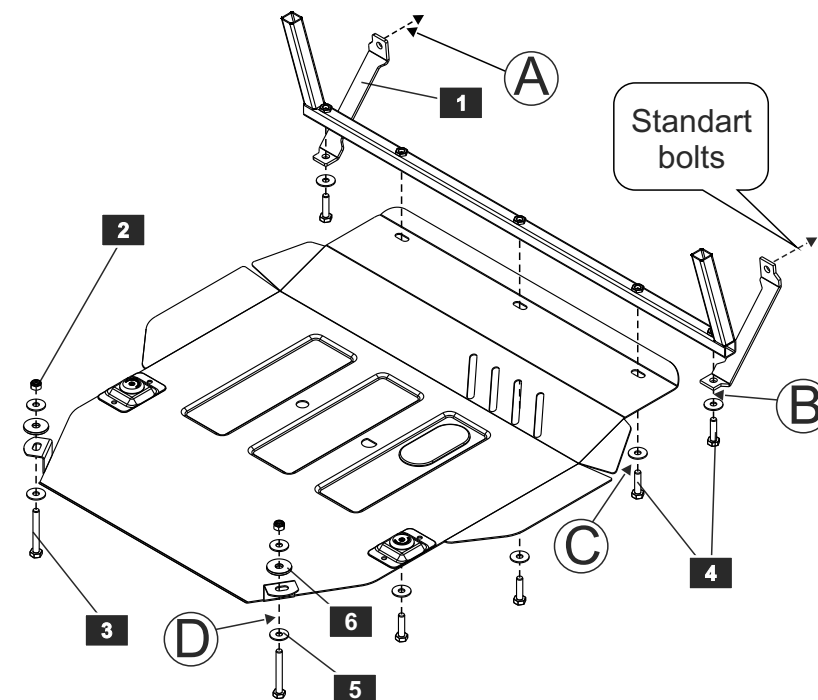

LIST OF PARTS

NO.	NAME	QTY.
1	Corbel	2
2	Nut M10	2
3	Bolt M10x80	2
4	Bolt M10x40	5
5	Washer 10	9
6	Special washer	2

Thread	M6x1.0	M8x1.25	M10x1.5	M12x1.75
Tightening torque	9.8 Nm	24.0 Nm	47.0 Nm	81.0 Nm